

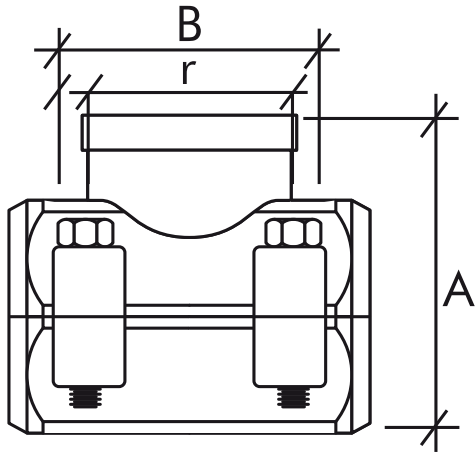

Referencia	Medidas	Características	u./caja
33063028	32-1/2	-	50
33063029	32-3/4	-	50
33063030	40-1/2	-	25
33063031	40-3/4	-	25
33063032	40-1"	-	25
33063033	50-1/2	-	25
33063034	50-3/4	-	25
33063035	50-1"	-	25
33063036	63-1/2	-	25
33063037	63-3/4	-	25
33063038	63-1"	-	25
33063039	75-1/2	-	15
33063040	75-3/4	-	15
33063041	75-1"	-	20
33063042	90-3/4	-	8
33063043	90-1"	-	8
33063044	90-1 1/4	-	8
33063045	90-1 1/2	-	8
33063046	90-2"	-	8
33063047	110-3/4	-	6
33063048	110-1"	-	6
33063049	110-1 1/4	-	6
33063050	110-1 1/2	-	6
33063051	110-2"	-	6

### Cotas



Referencia	Ø tubo/pipe	rosca/thread	A	B
33063028	32	1/2"	62	50
33063029	32	3/4"	62	50
33063030	40	1/2"	75	60
33063031	40	3/4"	75	60
33063032	40	1"	75	60
33063033	50	1/2"	83	72
33063034	50	3/4"	83	72
33063035	50	1"	83	72
33063036	63	1/2"	94	80
33063037	63	3/4"	96	80
33063038	63	1"	100	80
33063039	75	1/2"	115	93
33063040	75	3/4"	117	93
33063041	75	1"	120	93
33063042	90	3/4"	134	100
33063043	90	1"	135	100
33063044	90	1 1/4"	135	100
33063045	90	1 1/2"	136	100
33063046	90	2"	138	100
33063047	110	3/4"	156	114
33063048	110	1"	156	114
33063049	110	1 1/4"	159	114
33063050	110	1 1/2"	159	114
33063051	110	2"	160	114

## Documentación



## Instrucciones



## Tarifas

