

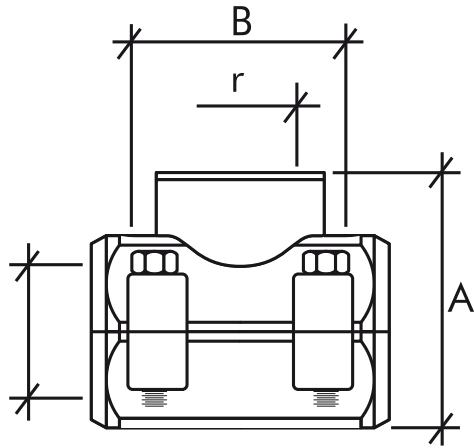

Referencia	Medidas	Características	u./caja
33062010	75-1/2	-	15
33062011	40-1/2	-	25
33062012	40-3/4	-	25
33062013	40-1"	-	25
33062014	50-1/2	-	25
33062015	50-3/4	-	25
33062016	50-1"	-	25
33062017	63-1/2	-	25
33062018	63-3/4	-	35
33062019	63-1"	-	25
33063011	75-3/4	-	20
33063012	75-1"	-	15
33063013	90-3/4	-	8
33063014	90-1"	-	8
33063015	90-1 1/4	-	8
33063016	90-1 1/2	-	8
33063017	90-2"	-	8
33063018	110-3/4	-	6
33063019	110-1"	-	6
33063023	110-1 1/4	-	6
33063024	110-1 1/2	-	6
33063025	110-2"	-	6
33063026	32-1/2	-	50
33063027	32-3/4	-	50

Cotas



Referencia	Ø tubo/pipe	rosca/thread	A	B
33062010	75	3/4"	115	93
33062011	40	1/2"	70	52
33062012	40	3/4"	75	60
33062013	40	1"	75	60
33062014	50	1/2"	83	72
33062015	50	3/4"	83	72
33062016	50	1"	83	72
33062017	63	1/2"	94	80
33062018	63	3/4"	96	80
33062019	63	1"	100	80
33063011	75	3/4"	117	93
33063012	75	1"	120	93
33063013	90	3/4"	134	100
33063014	90	1"	135	100
33063015	90	1 1/4"	135	100
33063016	90	1 1/2"	136	100
33063017	90	2"	138	100
33063018	110	3/4"	156	114
33063019	110	1"	156	114
33063023	110	1 1/4"	159	114
33063024	110	1 1/2"	159	114
33063025	110	2"	160	114
33063026	32	1/2"	62	50
33063027	32	3/4"	62	50

Documentación



Instrucciones



Tarifas

